

**Inlet Options**

**Inlet I PB, PS, P2B, L, T2B, CUI**

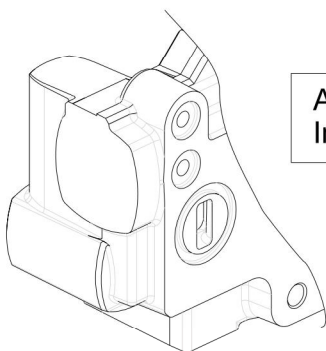
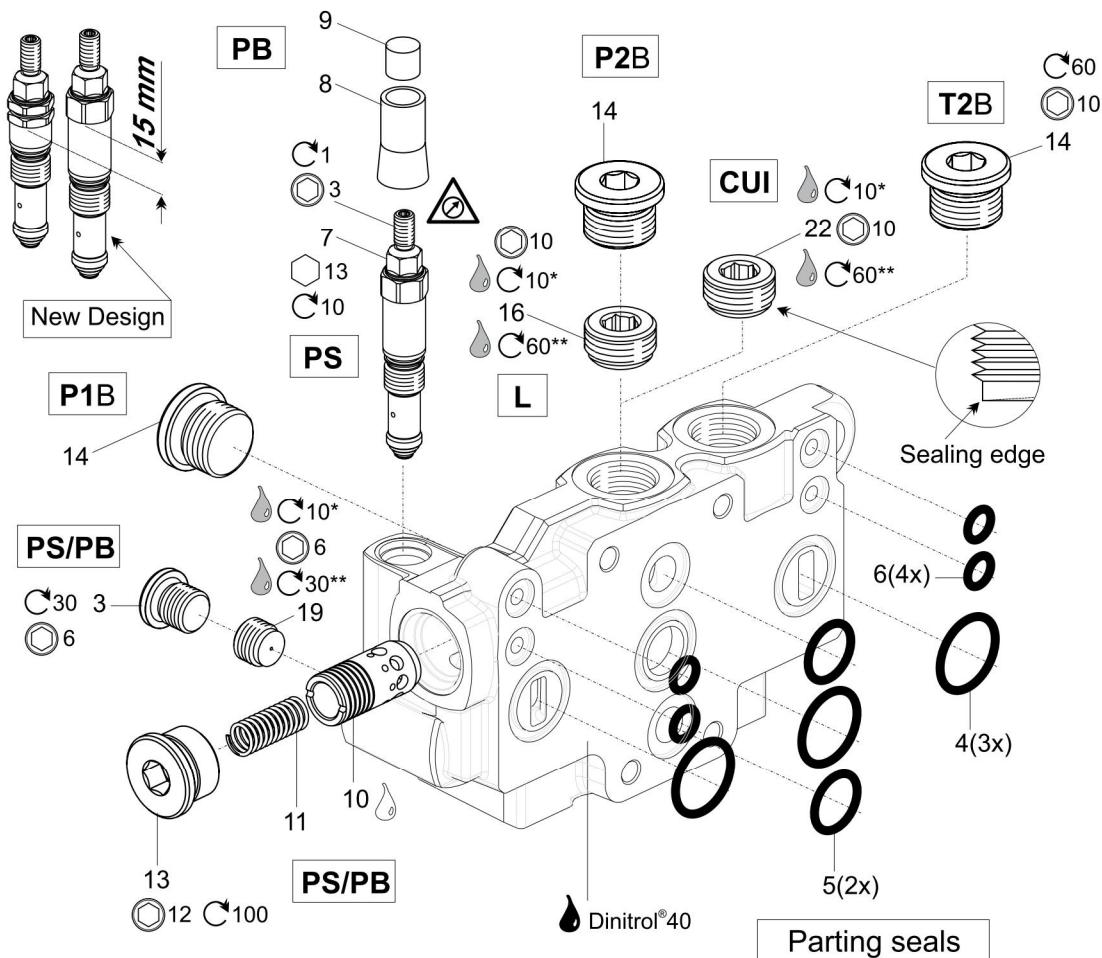

Alternative appearance,  
Inlet without Main relief

L, CUI, PS/PB, Items 16, 22, 19, \* Torque for inlets with serial # < 0517xxxxxxx  
 L, CUI, PS/PB, Items 16, 22, 19 \*\* Torque for inlets with serial # > 0517xxxxxxx  
 There's only one design of plugs, but cavities in new design inlet differ from inlet in old design.

**Inlet Options**

See Customer Specification				
Code	Pos	Part	Description	Remarks / Items
PS	16	398000K042	Main stage	10, 11, 13
PS	16	398000K069	Pilot part, main relief valve	7
PB	16	393000K852	Sealing set	8, 9
P1B, P2B, T2B	25, 26, 27	398000K004	P1, P2, T2 cavities plugged 'BSP'	14
P1B, P2B, T2B	25, 26, 27	398000K134	P1, P2, T2 cavities plugged 'UNF'	14
L	27	398000K047	Plug (parallel connection) BSP	16
L	27	398000K185	Plug (parallel connection) UNF	16
CUI	27	398000K226	Orifice (unloaded const. press.) BSP	22
CUI	27	398000K227	Orifice (unloaded const. press.) UNF	22
PS, PB	16	376910202	Plug	3
PS, PB	16	6760004	Orifice, BSP (5 pcs in kit)	19 (Not for CUI)
PS, PB	16	6760005	Orifice, UNF (5 pcs in kit)	19 (Not for CUI)
		398000K801	Parting seals	4, 5, 6 (NPR seals)
		398000V801	Parting seals, A002	4, 5, 6 (FPM seals)